

# LED M<sup>3</sup> TRACK LIGHT SYSTEM SERIES

## SES-MSE



### Technical Specifications

Size: See Reverse

Watts: 15W

Lumen: 1,200lm

CCT: 3000K | 4000K

Voltage: DC24V

Dimmable: DALI & 0-10V

Beam Angle: 120°

CRI: >90

IP Rate: IP20

Materials: Aluminum

Housing Color: Black, Frosted

Lifespan: 30,000 hours

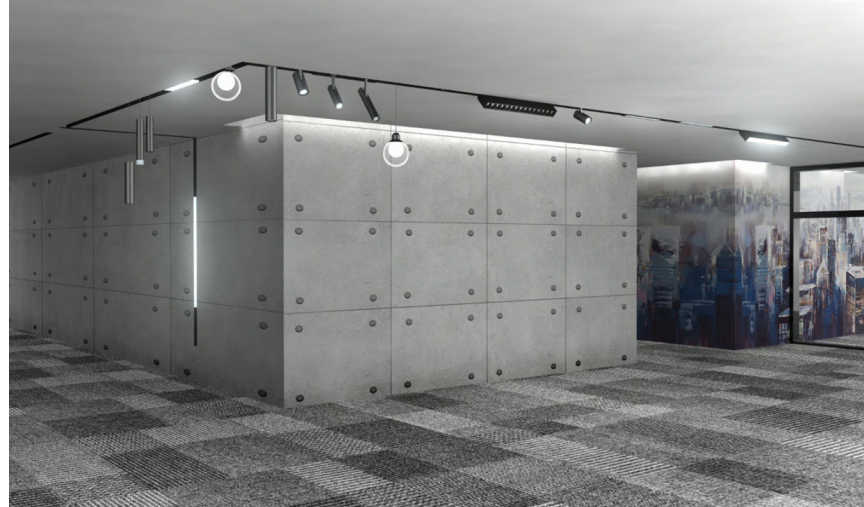
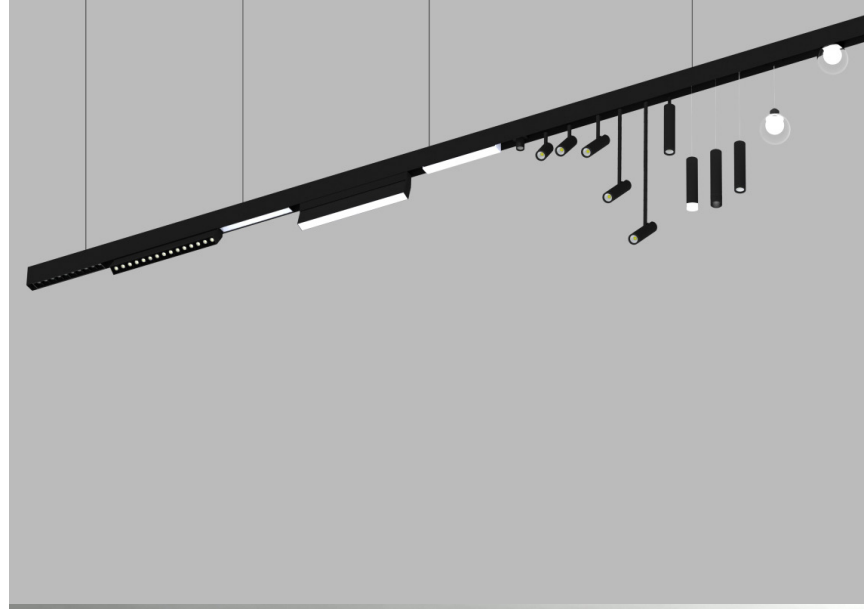

## Features

This M<sup>3</sup> Track Light System can be assembled in a wide variety of configurations due to its modular design. The rails are designed to be mounted on the surface, suspended or recessed. All of the interior components are easily hidden behind drywall or aluminum covers for a clean and finished aesthetic. Every light module in this series is compatible with both DALI and 0-10V dimmers.

## Dimensions

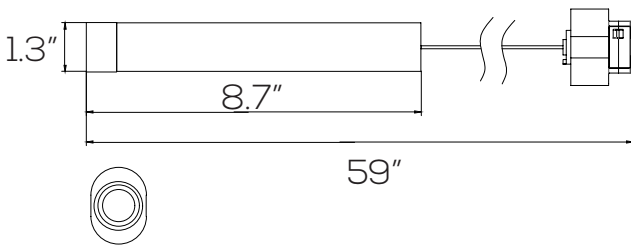

## Parts & Accessories



	Suspended Cylinder Light SES-MSE-15-3000-120D #32069		Feeder Cable SES-ME-FEEDER #42020-A		39.4" Cover SES-ME-COVER #42020-F
	Suspended Cylinder Light SES-MSE-15-4000-120D #32070		Corner H SES-MEN-CORNER-H #12022		End Cap SES-ME-CAP #42020-C
	Surface Mount Anchors SES-ME-ANCHORS #42020-G		Corner V SES-MEN-CORNER-V #12024		Intelligent Dimmer Switch SES-ME-SWITCH-1 #42020-K
	39.4" Suspension Cable Kit SES-ME-CABLE #42020-D		Corner H (Recessed) SES-MECN-CORNER-H #12023		0-10V Dimmer Switch SES-ME-SWITCH-2 #42020-L
	External Driver 350W SES-ME-DRIVER-350-48 #42020-H (0-10V / DALI)		Corner V (Recessed) SES-MECN-CORNER-V #12025		
	Internal Driver 150W SES-ME-DRIVER-150-48 #42020-J (DALI)		120° Corner SES-MELN-CORNER #32000		
	39.4" Track Rail SES-MEN-RAIL #12020		120° Corner V SES-MEN-CORNER-V-60 #32001		
	39.4" Track Rail (Recessed) SES-MECN-RAIL #12021		120° Corner 3V SES-MEN-CORNER-3V-60 #32002		
	Connector Kit SES-ME-CONNECTOR #42020-B		15" Pipe Kit SES-ME-PIPES #42020-E		